

- 1 Bolt on top plate.
- 2 Continuous 360° hydraulic rotation multi motors.
- 3 Reversed cylinder, protected rod.
- 4 Speed valve (except AS014R).
- 5 Body in high tensile steel.
- 6 Adjustment side guide for the mobile jaw.
- 7 Reversible blades, optimized cutting design.
- 8 Protected blade seats.
- 9 Protected front nose of the mobile jaw.

Options: central greasing.

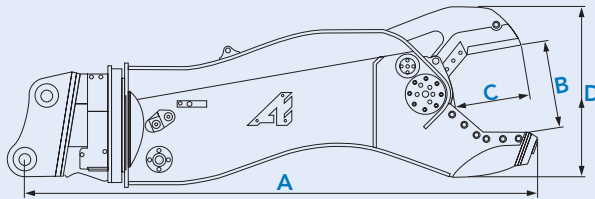
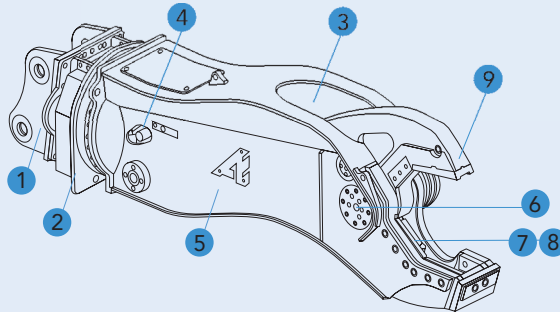
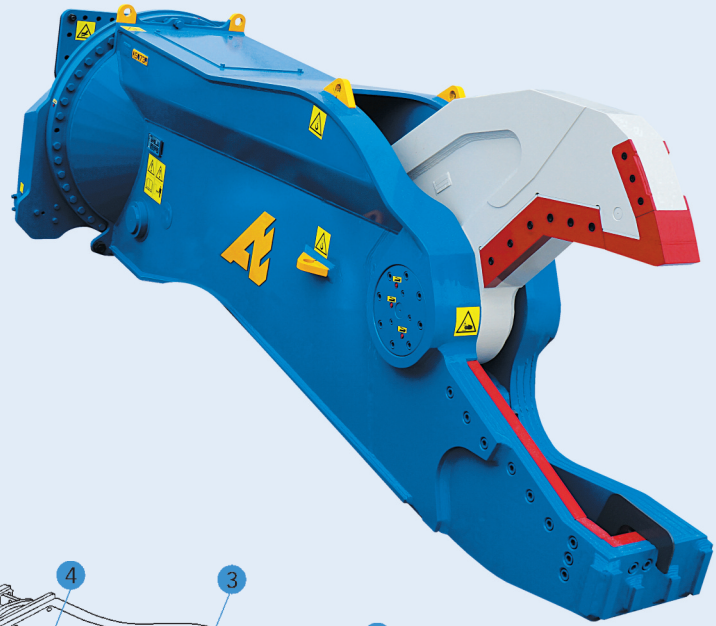

Model	kg*	A ~mm	B mm	C mm	D mm	L mm	IPE mm	IPN mm	HEA mm	Punching mm	mm	mm	bar***	l/s	Full cycle* s	360°			
																bar	l/s	***	***
AS-014R45	1 400	2693	435	485	831	345	300	260	160	10	50	172x7	350	200 maxi	5,3	140	14/20	9/11	13/21
AS-014R45 + opt.SV	1 430																		
AS-021R56	2 100	2 970	486	538	938	370	400	300	220	12	60	220x8	350	250 maxi	4,1		24/30	12/16	18/30
AS-030R61	3 000	3 415	560	610	1 062	390	450	360	260	14	70	305x10	350	400 maxi	3,7		28/40	16/21	24/39
AS-042R66	4 250	3 861	650	737	1 274	432	500	400	300	16	80	360x10	350	400 maxi	5,4		30/42	21/25	34/49
AS-042R70	4 450	3 900															35/45	-	40/60
AS-042R60FLE	4 550	3 590	745	809	1 392	455	600	450	360	20	90	400x12	350	400 maxi	6,9		35/45	24/32	-
AS-055R70	5 500	4 209															35/45	-	45/65
AS-055R60FLE	5 650	3 862	840	927	1 552	510	700	500	450	22	100	560x16	350	400 maxi	6		35/45	25/33	-
AS-055R80	5 950	4 267															40/60	-	50/75
AS-055R70FLE	6 100	3 929	840	927	1 552	510	700	500	450	22	100	560x16	350	400 maxi	6	40/60	33/40	-	
AS-055R70FLE + opt.SV 800	6 100	Valid for all types of AS-055R														550 maxi	5	-	-
AS-073R70FLE	7445	4 200	840	927	1 552	510	700	500	450	22	100	560x16	350	600 maxi	6	40/60	34/50	-	
AS-073R80	7360	4 540														-	50/85		

Weight (±3%) with top plate 2nd boom fitting for AS014R45, AS021R56, AS030R61 et AS042R66.
* For 1 full cycle at maxi oil flow. **Weight of carriers only for information, validation on request. *** Authorized maxi work pressure: 380 bar.
Cutting capacity for S235JR (E24-2) steel, at 350 bar in one shot with blades in good condition.